



ALSANIT®

LIFT

**LIFT**

CE

# LIFT cubicles made of mfc / hpl / sp

## Available in:

**MFC** - Laminated chipboard  
**HPL** - High Pressure Laminate  
**SP** - Sandwich panels

 Complementary products

page 6



## Description:

The LIFT cabins are a unique architectural solution for sanitary spaces where design plays a crucial role. LIFT is a line of cabins characterized by a recessed leg and an invisible reinforcing profile. From the front, this creates the impression that the cabins are suspended in the air, inspiring the name of this unique system.

LIFT cabins offer not only aesthetics but also solidity and durability, guaranteeing long-term use and maintaining an elegant appearance for many years.

The visual consistency of the project concept and the emphasis on cleanliness and hygiene are key elements that translate into positive user experiences.

The effect of floating cabins perfectly complements the prestige and elegance of facilities such as office buildings, hotels, or shopping centers. It is an excellent solution wherever interiors require exceptional style and a unique character.



only Torx screws are used



doors opening outward or inward



hinges with gravity self-closing



very high durability



tailor made to individual dimensions



**Impressive impression of lightness**



**CE certificate valid throughout the European Union**



**Fittings with a brushed steel finish**



**Fittings developed by ALSANIT are manufactured in Poland at the company headquarters**



**Production on CNC machines ensures precision and short lead times**



## Standard dimensions

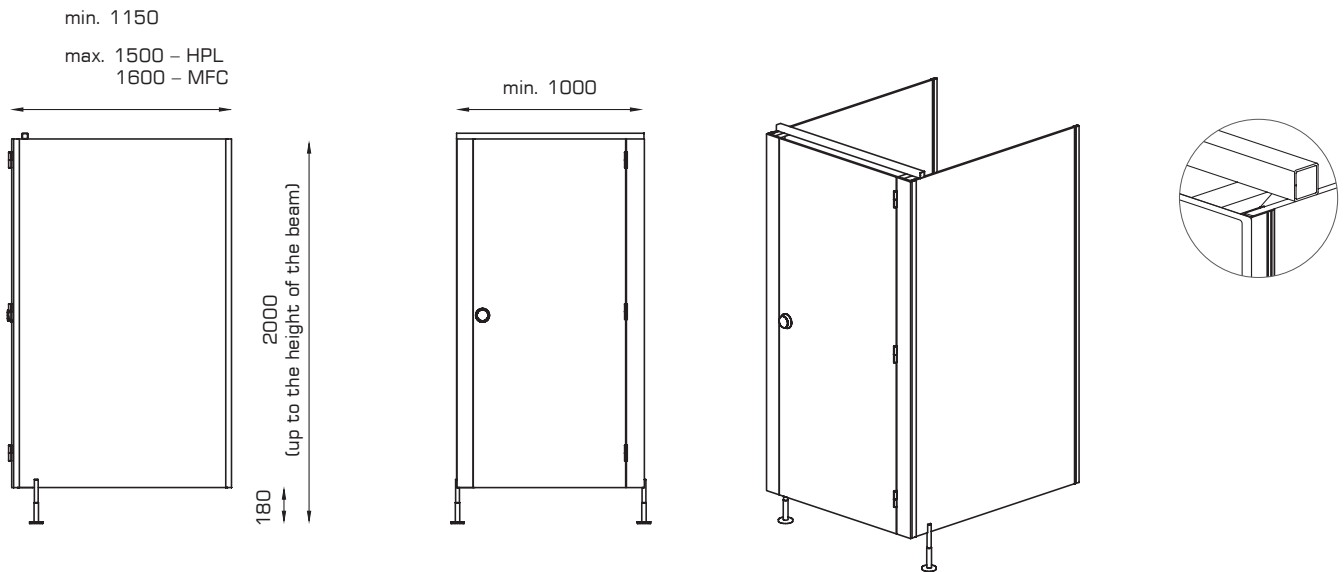

## Standard equipment

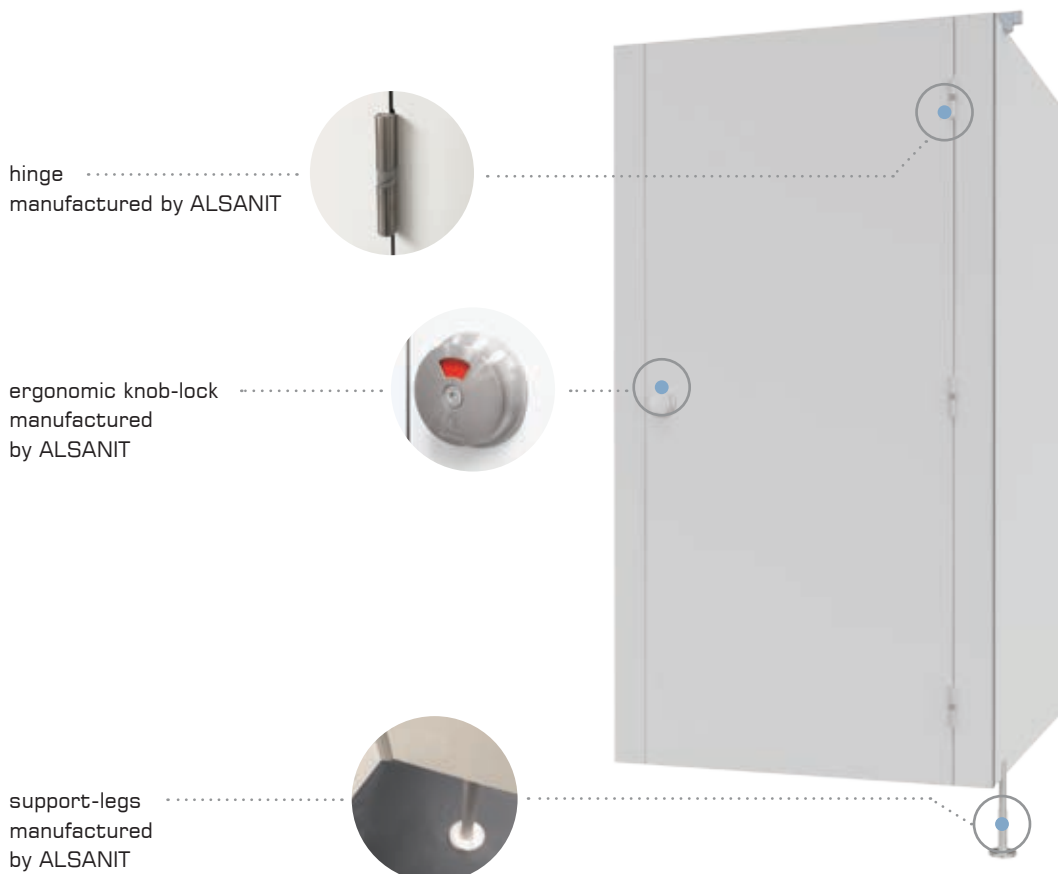

available  
colors

page 14 →



# LIFT construction details

## Construction details:

### Hinges

- tested durability: 200,000 open/close cycles
- typically for ALSANIT, mounted to narrow edges of panels
- made of brushed steel with a polyamide insert
- gravity self-closing
- minimalist appearance
- optionally - hinges for internal doors not visible from the outside

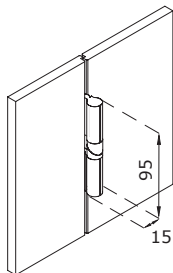

### Knob-locks

- elegant, ergonomic and highly durable
- emergency opening capability
- universal for left/right doors
- bolt rotation angle of 360°
- „click“ every 90°
- easy to use, including for individuals with disabilities
- white-red occupancy indicator

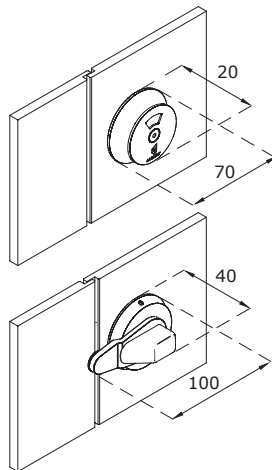

### Support-legs

- "hanging" cubicle effect
- made of brushed steel
- ensure easy leveling of partitions
- for 10-18 mm boards mounted to the side of the board, for 28 mm and thicker boards screwed into the core
- adjustment range +/- 20 mm
- rosette mounted on two dowels, covered with a plate

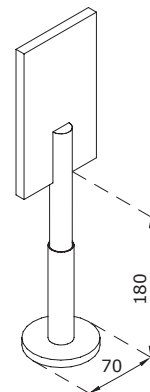

## Types of panels available for the system:

### MFC

Laminated chipboard

18 mm

28 mm

MFC is compressed under high temperature and pressure using binding agents with wood chips. The top layer is a decorative melamine coating.

- edges are finished with durable edging using HOT-AIR technology (glueless)
- suitable for rooms with normal humidity

Fire classification: Ds1d0



A solution for door frame for MFC boards



Support leg mounted on a partition wall



Rear-mounted beam



Wall and partition mounting

### HPL

High pressure laminate

10 mm

12 mm

HPL (High Pressure Laminate) - cellulose fibers saturated with resin and compressed under high pressure. The material is 100% waterproof and its properties are consistent throughout the entire board cross-section.

- milled edges-black core of the board is visible
- for rooms with high humidity

Fire classification: Cs1d0 - 10 mm, Bs1d0 - 12 mm (option)



A solution for door frame for HPL boards



Support leg mounted on a partition wall



Rear-mounted beam



Wall and partition mounting

### SP

Sandwich panels

36 mm

Panels with a total thickness of 36 mm - feature an aluminum frame filled with foamed polystyrene, 28 mm thick, with outer layers consisting of 4 mm HPL.

- excellent rigidity and aesthetics
- ideal for full-height installations
- provide the best soundproofing

Fire classification: Es1d0



A solution for door frame for SP boards



Support leg screwed into the core



Rear-mounted beam



Possibility of using a handle



Concealed mounting for walls and partitions



# URINAL PARTITIONS

**By using an aluminum rosette, we achieved an effect of exceptional lightness.**

ALSANIT urinal partitions are installed using rosettes, eliminating the need for support legs.

available  
colors

page 14





## Urinal partitions

- Powder-coated rosette in a color close to RAL 7035
- Easy installation
- Minimalist appearance

### MFC

- 18 mm
- 28 mm

### HPL

- 10 mm
- 12 mm

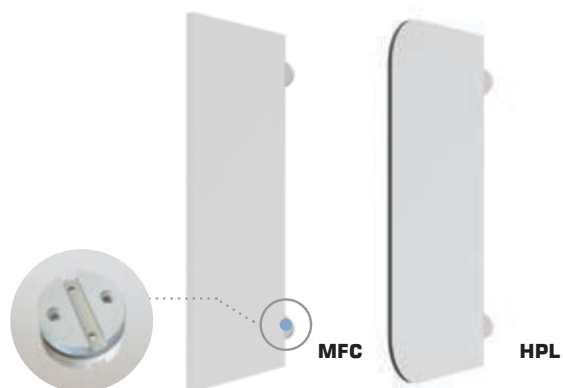
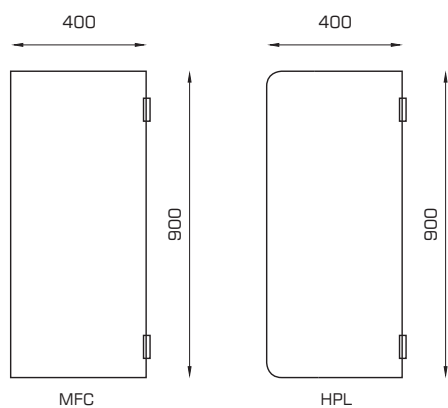





**Sink countertops are an important element of restroom furnishings.**

Due to the direct exposure to water, they need to be made of durable materials and properly installed.

available  
colors

page 14 →







## Vanity tops

- preparation for sink installation
- all visible edges routed
- need for panel joining for countertops longer than 2600 mm
- optionally additional mirror frames matching countertops

## HPL

10 mm

12 mm

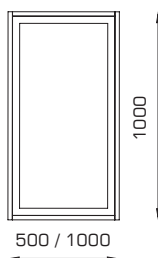
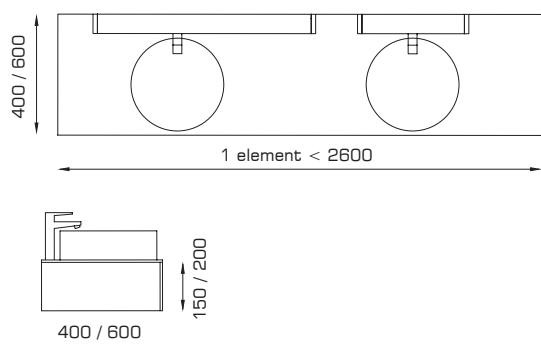



# SHOWERS

**Shower cubicles produced by ALSANIT are aesthetic, practical, and durable.**

Thanks to the use of durable, and fully waterproof materials, ALSANIT shower cubicles are an investment for many years. Showers are typically made basing on the SOLARI system fittings.

available  
colors

page 14



## „I” partitions

- easy and fast installation
- curtain included

HPL

10 mm

12 mm

← back

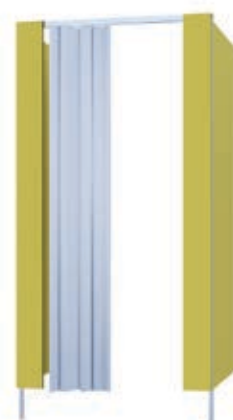
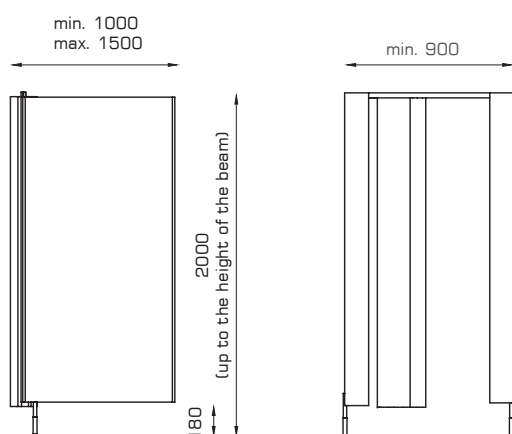

## Showers „T” i „F”

- additional space for storing clothes
- curtain included

HPL

10 mm

12 mm

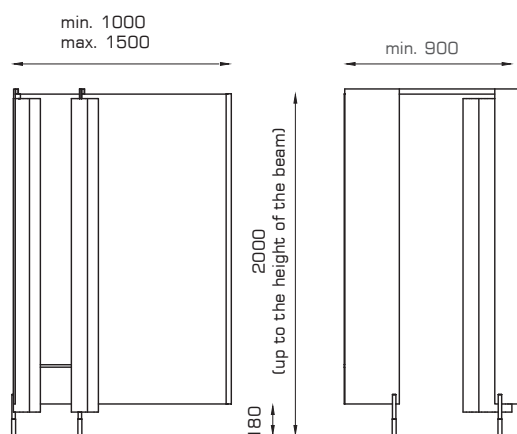

## Showers with doors

- doors reinforced with ribs approximately 80 mm wide
- round profile for clothes or towel between the ribs

HPL

10 mm

12 mm

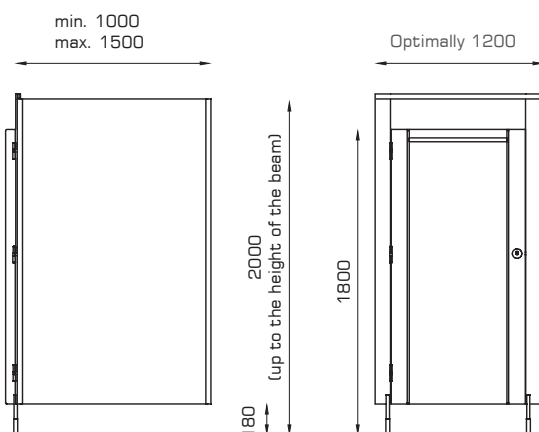



**Fast mounted and aesthetically pleasing wall claddings designed for large surfaces.**

TECHNOWALL is a fully proprietary system of wall claddings with quick access to installations located behind them.

available  
colors

page 14 →



## HPL

10 mm

12 mm

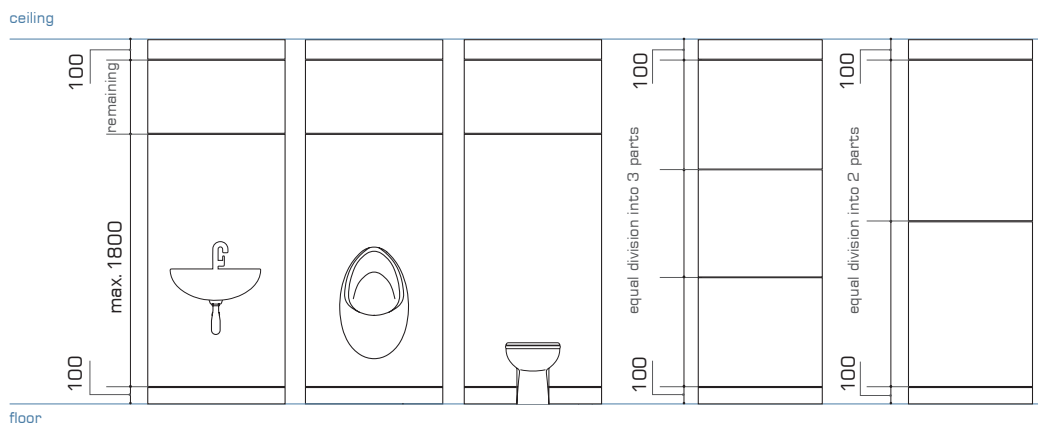

## Installation:



1. Level and mount the bottom profile to the floor.

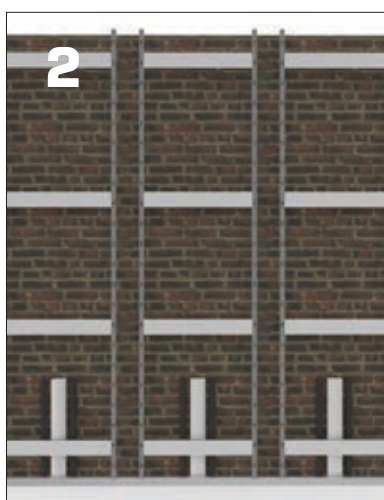

2. Place the steel frames for cladding on the profile, align, and attach them to the masonry wall.



3. Connect the frames with „shadow” panels. Mount masking panels at the bottom and top.

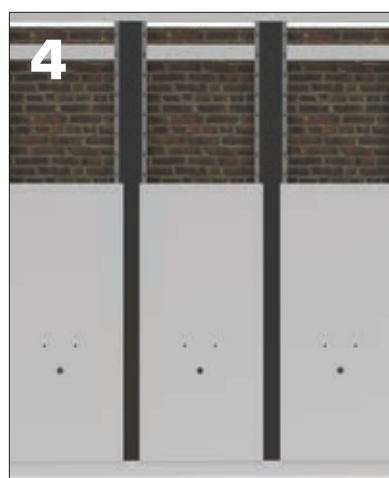

4. Fit the cladding panels up to the height of the utilities and fixtures. For the cladding where fixtures will be installed, cut openings for the connections/fixtures.



5. Secure and connect the fixtures to the cladding.



6. Install the remaining cladding.

# COLORS stock collection

## HPL

- LOCKERS
- HPL BUILT-INS
- CUBICLES
- CONTRACT FURNITURE

4,10,12 mm

CLASSIC WHITE

~ RAL 9016

4,10,12 mm

PERFECT GREY

~ RAL 7035

4,10,12 mm

SILESIA GREY

~ RAL 7043

10 mm

JUICY LEMON

~ RAL 1016

10 mm

JUICY ORANGE

~ RAL 2004

10 mm

RED DELUXE

~ RAL 3020

10 mm

FRESH GREEN

~ RAL 6038

10 mm

SPICE ORANGE

~ RAL 2008

10 mm

FOREST GREEN

~ RAL 6018

10 mm

EMERALD LAGUN

~ RAL 5018

10 mm

BLUE BAY

~ RAL 5005

10,12 mm

SHADOW GREY

~ RAL 7042

10 mm

CLASSIC BLACK

~ RAL 9005

10 mm

LION WOOD

HORIZONTAL

standard colors of locker bodies

standard colors of Sandwich Panels

colors available only for lockers and furniture

## METAL

- LOCKERS

PURE WHITE

~ RAL 9010

PERFECT GREY

~ RAL 7035

COAL GREY

~ RAL 7016

JUICY ORANGE

~ RAL 2004

RED HOT

~ RAL 3000

FOREST GREEN

~ RAL 6018

OCEAN BLUE

~ RAL 5010

MARINA BLUE

~ RAL 5015

CLASSIC BLACK

~ RAL 9005

standard colors of locker bodies

\* sample colors



## MFC

[LOCKERS](#)
[CUBICLES](#)
[CONTRACT FURNITURE](#)

the color range is also available in the **HIGH GLOSS** version

## GLASS

[LOCKERS](#)
[CUBICLES](#)

\* sample colors



**20+**

20 years of experience

**25+**

sales to over 25 countries

**2600+**

2600 projects annually

**8000+**

sqm of ALSANIT's hall space

**40000+**

doors produced annually

**We offer the LIFT system to clients who do not use standard solutions.**

So that each room has its own unique, difficult-to-replicate style.



ALSANIT®

Alsanit Sp. z o.o.  
ul. Wieleńska 2, 64-980 Trzcianka, POLSKA

+48 67 253 23 60  
alsanit@alsanit.pl  
www.alsanit.pl